

GAMA SONIC[®]

SOLAR LIGHTING

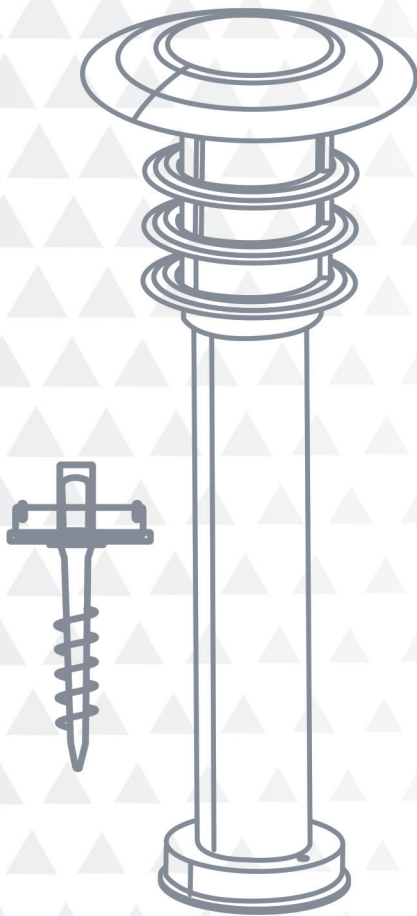

STAINLESS STEEL BOLLARD SOLAR LAMP with EZ Anchor

Model: 214801 / 214001

US Patent #9458970

 Please read the instruction manual carefully to obtain the best results from your purchase.

Thank you for your purchase. GAMA SONIC® solar charged accent lighting eliminates the problems associated with most solar lighting available today. GAMA SONIC® solar charged lights are brighter and last all night with a typical solar charge. Unique design, superior light output, and numerous installation options confirm the outstanding value of our product.

GAMA SONIC® has been recognized as a worldwide leader in the lighting industry for over 20 years. The company also offers unique multi-purpose rechargeable products that range from party lights to emergency lighting products.

For technical assistance and more information
call our Toll-Free number:
800-835-4113 (only within the US)

Or



visit our website or download the latest version
of your instruction manual:
www.gamasonic.com Or
www.gamasonic.com/user-guides



Solar Lamp Location:

For optimum light duration throughout the night, it is very important to place your solar light in a spot where it will receive the maximum amount of direct sunlight throughout the day.

Note: For best results, the solar light must be charged on the "ON" position for two sunny days.

Adaptor	Auger	Turning Bar
	 <p>← Level Tool</p> <p>← Ground Stop Ring</p>	



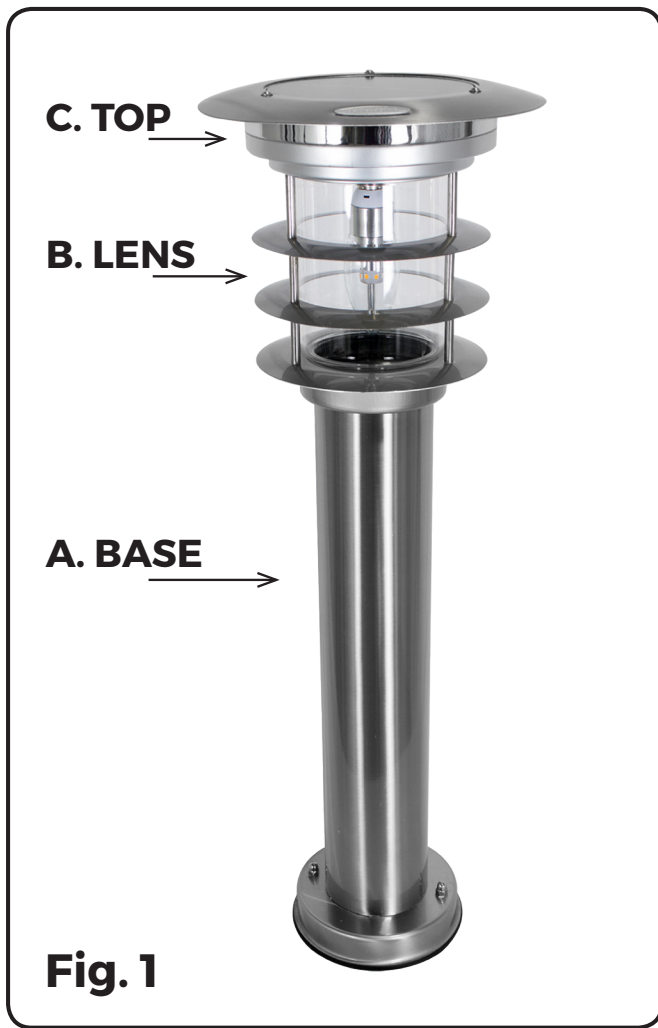
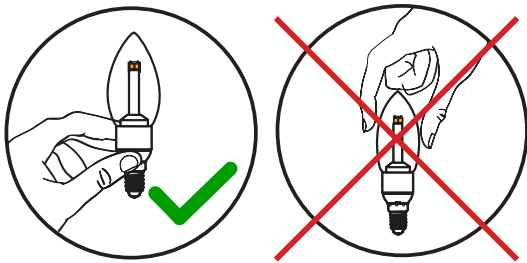

Fig. 1



WARNING: GAMA SONIC® Light bulbs are not to be used in other electrical sockets these are low-voltage light bulbs that are built and designed for our products only!



Fig. 2



Fig. 3

Operation and assembly instructions.

1. Remove the Adaptor from the base by unscrewing the two silver caps from the bottom of the base, Part A.
2. Remove protective nylon bag from lens, Part B.
3. Screw Part B into the base, Part A.
NOTE: If the two parts do not easily fit, try inserting Part B into Part A at an angle until the glass starts to thread in.
4. Remove the GS Solar Bulb from its box, and insert it in the top, Part C.
5. Set operation setting to High or Low setting, and install the top, Part C (Fig.2), into Part B by twisting clockwise.

• Solar light will automatically operate dusk-to-dawn.

Flat surface installation Instruction

1. Use the Adaptor as a template to drill two holes in the desired mounting location.
2. Secure the Adaptor to the surface using the provided anchors.
3. Attach the assembled lamp to the Adaptor and secure using the silver caps

EZ Anchor installation

1. Place the Adaptor onto the Auger bit. Secure it with the four supplied screws.
2. Place the Turning Bar in the hole through the Auger bit, Fig. 3.
3. Install Auger in desired location and apply downward pressure while turning the Turning Bar clockwise.
4. Occasionally check the Level Tool on the Auger to ensure the Auger is vertical.
5. Stop turning once the Ground Stop Ring has reached ground level.
6. Place the Bollard light on top of the adaptor and secure it with the two nuts.



Replacing the Batteries

Replacement batteries are available
at www.gamasonic.com or via our Toll free number: +1-800-835-4113

(After several years of use, the batteries may need replacing).

1. Remove the solar panel cap from the pole by twisting counter clockwise.
2. Unscrew and remove the battery compartment covers (Fig. 2).
3. Unclip the connector and remove the old batteries. Make sure the new batteries are high quality 3.2V/1,000mAh, Li-ion Rechargeable battery with connector.
4. Clip on new battery and install into the battery compartment. Re-install the battery compartment covers.
5. Reattach the solar panel cap to the pole.



WARNING: Do not dispose of Li-Ion batteries in the regular trash, municipal waste stream or by fire as batteries may leak or explode. Do not open, short circuit, or mutilate batteries as injury may occur. Preserve our environment by recycling Li-Ion batteries or disposing of them in accordance with local, State and federal regulations. Do not mix old and new batteries.

Maintenance

Clean the solar module regularly with a damp towel to guarantee optimum performance of the solar panel. Do not use any type of solvent for cleaning and be careful not to put too much pressure on the module while cleaning.

Trouble Shooting

If your solar charged light does not come on at dusk despite observance of all the instructions, please try the following steps:

1. Make sure that the solar light is not being affected by any other light source.
2. Ensure the solar light is not positioned in the shade during the day.
3. Make sure the switch in the lamp head is in the "LOW" or "HIGH" position.
4. Check that the batteries are installed correctly.

NOTE: The performance of the solar light will vary with the time of year. It will deliver longer duration when it has had a full day in the sun rather than a day in overcast weather.



WINTERTIME TIPS: For optimal performance, be sure to remove any snow or debris accumulation from solar panel(s). A solar panel free of debris will charge the batteries much more efficiently.

WARNING: Please keep out of reach of children.

