

# FLF FLOOD LIGHT

## LED Flood Light with Selectable CCT and Lumen



**Contractor Essentials**  
LIGHT MORE, PAY LESS  
BY LIGHT BULB SURPLUS

### Introduction

- ◆ This FLF multipurpose floodlight has a slim, traditional low profile design. The die-cast aluminum housing guarantees the durability and efficiency of the lamp to resist the attack of severe weather.
- ◆ The FLF uses a tempered glass cover to protect the LED chip from damage and help diffuse the light. With field lumen and CCT selectable switches, FLF will provide a quick, easy and adjustable solution.
- ◆ It has 3 kinds of mounting brackets to choose from, namely Knuckle mount, Trunnion mount, and Slipfitter mount. The mounting bracket is adjustable to allow different angles and directions of light, and is designed to withstand strong winds or other environmental elements.
- ◆ The FLF Series optional floodlight range offers simple outdoor solutions for a variety of floodlighting applications, ideal for signs, facades, car parks and more.



### Product Specifications



#### Construction:

- ◆ Die-casting aluminum housing and durable surface powder coating spray. Fully sealed tempered glass.

#### Electrical:

- ◆ 0-10V dimmable driver, dimming wire does not lead out from the fixture.
- ◆ The Input voltage is AC120-277V/AC277-480V (50/60Hz).
- ◆ 2ft (24") long power cord provided for easier installation. (Supply 0.7 ft (7.8") of electrical wire for the flood light equipped with a knuckle mount.)

#### Optics:

- ◆ Selectable CCT 3000K, 4000K or 5000K (Default setting), CRI >70.
- ◆ Three distributions are available, NEMA 7H7V for 30W~155W, NEMA 4H4V and NEMA 6H6V for 250W.

#### Photocell:

- ◆ Integrated photocell included with on/off switch.

#### Finish:

- ◆ Dark bronze color is Standard.

#### Mounting:

- ◆ Support Knuckle mount, Trunnion mount, and Slipfitter mount for optional.

#### Ambient Temperature:

- ◆ -40° F (-40° C) to 113° F (45° C)

#### Compliances:

- ◆ cULus listed for wet locations.
- ◆ DLC® (DesignLights Consortium) Qualified. Please refer to the DLC website for specific product qualifications at [www.designlights.org](http://www.designlights.org).

#### Warranty:

- ◆ 5 Year Warranty

### Ordering Guide

EXAMPLE: X-FLF(155/125/90)W-(30/40/50)KLV-PTR

Brand	Product name FLF	Wattage <sup>1</sup> XXXW	CCT <sup>2</sup> XXK	Input Voltage <sup>3</sup> AA	Photocell X	Mounting Brackets YY	Distribution Z	Efficacy K
LBS	FLF	(30/25/17)W (63/50/36)W (108/90/63)W (155/125/90)W (250/200/150/125)W	30K=3000K 40K=4000K 50K=5000K (30/40/50)K= 3000K/4000K/5000K	LV=120-277Vac UV=120-277Vac HV=277-480Vac	Blank=without photocell, P=with photocell	TR=Trunnion Mount SF=Slipfitter Mount KN=Knuckle Mount	Blank= Wide Distribution 7H7V M= Medium Distribution 6H6V N=Narrow Distribution 4H4V	Blank=General Light Efficacy H=High Light Efficacy

Note: 1. (30/25/17)W=30W, 25W, 17W Selectable, 30W default setting. (63/50/36)W=63W, 50W, 36W Selectable, 63W default setting. (108/90/63)W=108W, 90W, 63W Selectable, 108W default setting. (155/125/90)W=155W, 125W, 90W Selectable, 155W default setting. (250/200/150/125)W=250W, 200W, 150W, 125W Selectable, 250W default setting.

2. (30/40/50)K=3000K, 4000K, 5000K Selectable, 5000K default setting.

3. The Voltage code (120-277Vac) of 30W~155W is LV. The Voltage code (120-277Vac) of 250W is UV.

## Performance Data

Model	Wattage	Lumen @5000K	CCT	Input voltage
X-FLF(30/25/17)W-(30/40/50)KAA-PYY	(30/25/17)W	Max. 5,100lm	(30/40/50)K selectable	AC120-277V AC277-480V 50/60Hz
X-FLF(63/50/36)W-(30/40/50)KAA-PYY	(63/50/36)W	Max. 9,765lm		
X-FLF(108/90/63)W-(30/40/50)KAA-PYY	(108/90/63)W	Max. 17,280lm		
X-FLF(155/125/90)W-(30/40/50)KAA-PYY	(155/125/90)W	Max. 24,025lm		
X-FLF(250/200/150/125)W-(30/40/50)KAA-YYZ	(250/200/150/125)W	Max. 37,500lm		
X-FLF(250/200/150/125)W-(30/40/50)KAA-YYZH	(250/200/150/125)W	Max. 42,500lm		
X-FLF(250/200/150/125)W-XXKAA-YYZ	(250/200/150/125)W	Max. 37,500lm	3000K or 4000K or 5000K	
X-FLF(250/200/150/125)W-XXKAA-YYZH	(250/200/150/125)W	Max. 42,500lm		

## Photometrics

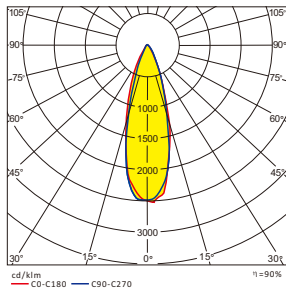

NEMA 4H4V  
for 250W

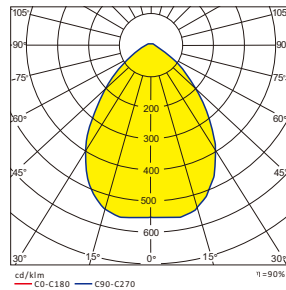

NEMA 6H6V  
for 250W

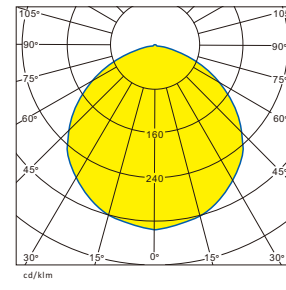

NEMA 7H7V  
for 30W~155W

## Power Selection And CCT Selection Capability

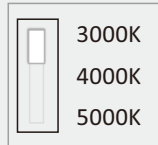
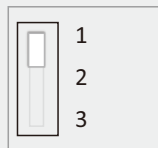
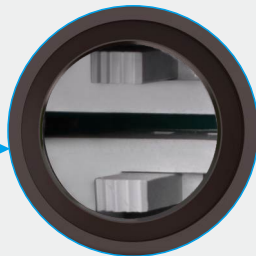

### Power Setting

Adjust power between  
30/25/17W, 30W default setting.  
63/50/36W, 63W default setting.  
108/90/63W, 108W default setting.  
155/125/90W, 155W default setting.

### CCT Setting

Adjust CCT between  
3000K/4000/5000K, 5000K default setting.

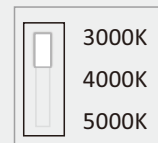
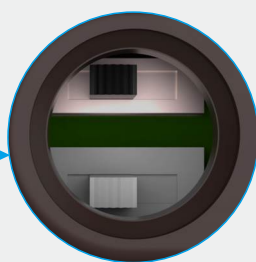

### Power Setting

Adjust power between  
250/200/150/125W, 250W default setting.

### CCT Setting

Adjust CCT between  
3000K/4000/5000K, 5000K default setting.

## Accessories

### Control Options

Comes as standard



### Control Options

Call to confirm availability



## Electrical Data

Model Series	Wattage(W)	Current (A)				
		Input Voltage (V)				
		120	208	240	277	480
X-FLF(30/25/17)W	17	0.16	0.09	0.08	0.07	N.A
	25	0.23	0.13	0.12	0.10	N.A
	30	0.28	0.16	0.14	0.12	N.A
X-FLF(63/50/36)W	36	0.33	0.19	0.17	0.14	N.A
	50	0.46	0.27	0.23	0.20	N.A
	63	0.58	0.34	0.29	0.25	N.A
X-FLF(108/90/63)W	63	0.58	0.34	0.29	0.25	N.A
	90	0.83	0.48	0.42	0.36	N.A
	108	1.00	0.58	0.50	0.43	N.A
X-FLF(155/125/90)W	90	0.83	0.48	0.42	0.36	0.21
	125	1.16	0.67	0.58	0.50	0.29
	155	1.44	0.83	0.72	0.62	0.36
X-FLF(250/200/150/125)W	125	1.16	0.67	0.58	0.50	0.29
	150	1.39	0.80	0.69	0.60	0.35
	200	1.85	1.07	0.93	0.80	0.46
	250	2.31	1.34	1.16	1.00	0.58

## Dimensions

1/2"NPSM Knuckle Mount	LxWxH
(30/25/17)W	9.8x7.0x2.3inch/250.1x177.0x57.3mm
(63/50/36)W	10.8x8.0x2.5inch/275.1x202.2x62.3mm

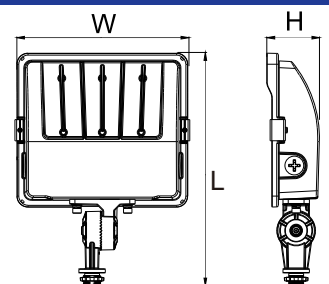

1/2"NPSM Knuckle Mount

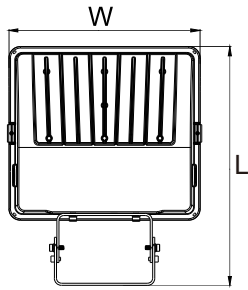

(30/25/17)W  
 (63/50/36)W  
 (108/90/63)W  
 (155/125/90)W

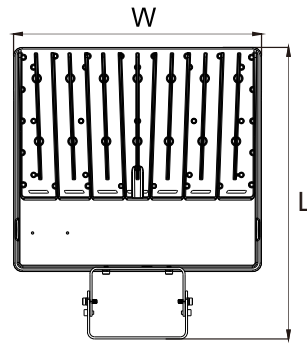

(250/200/150/125)W

Trunnion Mount	LxWxH
(30/25/17)W	8.7x7.0x2.3inch/220.5x177.0x57.3mm
(63/50/36)W	9.7x8.0x2.5inch/245.6x202.2x62.3mm
(108/90/63)W	11.8x9.2x2.9inch/300.3x232.6x73.6mm
(155/125/90)W	13.5x10.7x2.9inch/342.3x272.6x73.6mm
(250/200/150/125)W	16.4x14.0x2.6inch/416.7x354.5x66.6mm

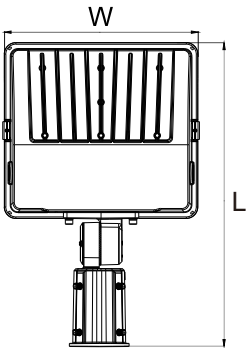

(108/90/63)W  
 (155/125/90)W

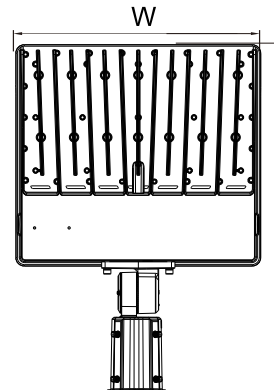

(250/200/150/125)W

Slipfitter Mount	LxWxH
(108/90/63)W	15.3x9.2x2.9inch/387.6x232.6x73.6mm
(155/125/90)W	16.8x10.7x2.9inch/427.8x272.6x73.6mm
(250/200/150/125)W	19.8x14.0x2.6inch/504.0x354.5x66.6mm

### Drilling Patterns

Knuckle Mount for FLF 30-63W

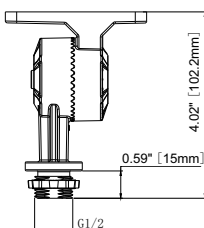

Trunnion Mount for FLF 30-63W

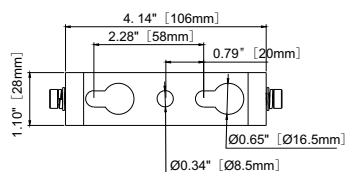

Trunnion Mount for FLF 108-250W

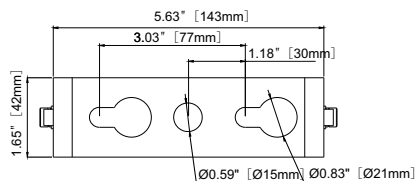

Slipfitter Mount for FLF 108-250W

