

SINCE 1945
KEYSTONE

CELEBRATING 75 YEARS

FUTURE FIT®
LIGHT ENGINES

NEW! Adjustable wattage and color temperature
for maximum versatility.



The New Generation of Future Fit LED Kits



Keystone's innovative Future Fit LED kits are now more versatile and efficient than ever before. With our new Power Select and Color Select features, lumen output and color temperature can be selected with a simple switch. Form factors and lumen package options remain the same. Look for the Power Select and Color Select logos throughout this brochure to know which Future Fit products are equipped with this innovative feature.

Why retrofit when you can Future Fit?

Future Fit LED kits are the ideal solution to easily upgrade legacy fixtures into energy-efficient, long lasting LED systems. We pre-package your desired Keystone drivers, modules, and mounting accessories for easy installation either in the field or at the point of manufacture. With each kit already safety tested and performance verified, upgrading to LED doesn't get any easier than Future Fit kits, only from Keystone.

FEATURES AND BENEFITS FOR ALL FUTURE FIT PRODUCTS:



Safety Tested



Low Flicker



Smooth Dimming



Easy Installation



Flexible Mounting



SKU Reduction

FREE PRODUCT SAMPLES AVAILABLE UPON REQUEST.

Call 800.464.2680 or email us at samples@keystonetech.com

TABLE OF CONTENTS



LINEAR LED KITS WITH ALUMAGROOVE®

2 **NEW!** Power Select Linear Kits with AlumaGroove



LIGHT ENGINE KITS

4 **NEW!** Power Select and Color Select Circular Kits

6 **NEW!** Power Select and Color Select Rectangular Kits



FUTURE FIT® **AC** AC LED LIGHT ENGINE KITS

8 Future Fit AC LED Light Engine Kits

NEW! POWER SELECT LINEAR KITS WITH ALUMAGROOVE™



APPROVED FOR USE IN
VAPOR TIGHT FIXTURES



High efficacy linear LED modules pre-mounted into aluminum extension via a patented manufacturing method
Each kit includes (1) LED driver, (2) AlumaGroove LED modules, (2) optional diffused lenses, mounting hardware, and accessories

SYSTEM FEATURES

- Power level/lumens are selectable via slide switch
- UL Classified 1598C; made with UL recognized components
- Dimmable with 0-10V dimmers
- High lumen density design and improved efficiency
- For use in Class 2 lighting systems
- UL classified for field installation
- 2835 LED chip package
- Beam angle: 120°
- Low-profile WAGO push connectors located on bottom of modules to eliminate dark spots on end-to-end connections
- Completely heat sunked, no additional heat sinking needed to maintain LED lifetime
- Optional diffused lenses are available for all lengths and are included with each kit
- Ideal retrofit for vapor tight fixtures; commonly used in troffer, wrap, strip, and vapor tight applications
- Meets FCC Part 15 Class B (consumer) limit for EMI
- Operating temperature: -20°C/-4°F to 55°C/131°F
- THD: <20%



1' Linear Kit • 80 CRI • Selectable Output Power

Catalog Number	No. of Modules	Input Voltage	Dimming Type	Selectable Output Current	Total System Power	Color Temp.	CRI	Total System Lumens	System Efficacy
KT-RKIT-20PS-2AG11-8xx-VDIM	2	120-277V	0-10V	330mA	10.6W	3500K	>80	1,550	146 lm/W
						4000K	>80	1,580	149 lm/W
						5000K	>80	1,642	155 lm/W
				500mA	16.3W	3500K	>80	2,333	143 lm/W
						4000K	>80	2,374	146 lm/W
						5000K	>80	2,413	148 lm/W
				600mA	19.8W	3500K	>80	2,730	138 lm/W
						4000K	>80	2,760	139 lm/W
						5000K	>80	2,837	143 lm/W

APPROVED FOR USE IN
VAPOR TIGHT FIXTURES



NEW! POWER SELECT LINEAR KITS WITH ALUMAGROOVE™

2' Linear Kit • 80 CRI • Selectable Output Power

Catalog Number	No. of Modules	Input Voltage	Dimming Type	Selectable Output Current	Total System Power	Color Temp.	CRI	Total System Lumens	System Efficacy
KT-RKIT31PS-2AG22-8xx-VDIM	2	120-277V	0-10V	570mA	17.6W	3500K	>80	2,907	165 lm/W
						4000K	>80	2,936	167 lm/W
						5000K	>80	2,997	170 lm/W
				780mA	24.4W	3500K	>80	3,868	159 lm/W
						4000K	>80	3,909	160 lm/W
						5000K	>80	3,989	164 lm/W
				1000mA	31.5W	3500K	>80	4,964	158 lm/W
						4000K	>80	5,014	159 lm/W
						5000K	>80	5,116	162 lm/W

4' Linear Kit • 80 CRI • Selectable Output Power

Catalog Number	No. of Modules	Input Voltage	Dimming Type	Selectable Output Current	Total System Power	Color Temp.	CRI	Total System Lumens	System Efficacy
KT-RKIT35PS-2AG44-8xx-VDIM	2	120-277V	0-10V	760mA	22.7W	3500K	>80	3,979	175 lm/W
						4000K	>80	4,009	177 lm/W
						5000K	>80	4,049	178 lm/W
				960mA	29.1W	3500K	>80	4,950	170 lm/W
						4000K	>80	4,987	171 lm/W
						5000K	>80	5,087	175 lm/W
				1150mA	35.3W	3500K	>80	5,890	167 lm/W
						4000K	>80	5,936	168 lm/W
						5000K	>80	6,036	171 lm/W

TYPICAL INSTALLATION APPLICATION



*8xx denotes several color temperatures available..

835 800 Series, 3500K **840** 800 Series, 4000K **850** 800 Series, 5000K

NEW! 8" POWER SELECT AND COLOR SELECT CIRCULAR LED KITS

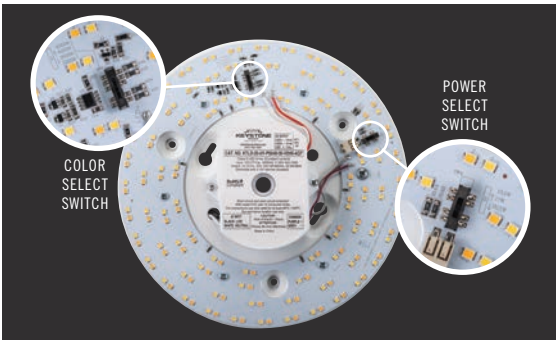

Each pre-assembled UL Classified kit includes (1) dimmable LED driver, (1) LED module, (1) metal pan, mounting hardware, and accessories

SYSTEM FEATURES

- Power level and color temperature are selectable via slide switches
- Dimmable with 0-10V dimmers
- Minimum dimming level: 10%
- UL Classified; meets FCC Part 15, Class B (Consumer) limit
- Beam angle: 120°
- THD: <20%
- Pre-assembled; mounting accessories included
- Operating temperature: -20°C/-4°F to 45°C/113°F

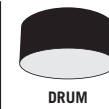

8" Circular Kit • Selectable Output Power • Selectable Color Temperature

Catalog Number	Input Voltage	Dimming Type	Selectable Wattage	Selectable Color Temp.	CRI	Total Lumens	System Efficacy
KT-RKIT20PS-8CP-8CSC-VDIM	120-277V	0-10V	13.5W	3000K	> 80	2,100	156 lm/W
				3500K	> 80	2,125	157 lm/W
				4000K	> 80	2,150	159 lm/W
				5000K	> 80	2,200	163 lm/W
			17W	3000K	> 80	2,650	156 lm/W
				3500K	> 80	2,675	157 lm/W
				4000K	> 80	2,700	159 lm/W
				5000K	> 80	2,750	162 lm/W
			20.5W	3000K	> 80	3,100	151 lm/W
				3500K	> 80	3,125	152 lm/W
				4000K	> 80	3,150	154 lm/W
				5000K	> 80	3,200	156 lm/W

TYPICAL INSTALLATION APPLICATION



NEW! 13" POWER SELECT AND COLOR SELECT CIRCULAR LED KITS

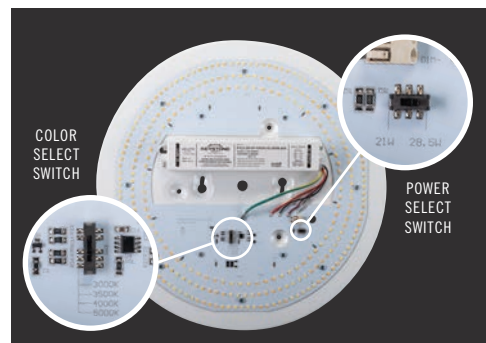

Each pre-assembled UL Classified 1598C kit includes (1) dimmable LED driver, (1) LED module, (1) metal pan, mounting hardware, and accessories

SYSTEM FEATURES

- Power level and color temperature are selectable via slide switches
- Dimmable with 0-10V dimmers
- Minimum dimming level: 10%
- UL Classified; meets FCC Part 15, Class B (Consumer) limit
- Beam angle: 120°
- THD: <20%
- Pre-assembled; mounting accessories included
- Operating temperature: -20°C/-4°F to 45°C/113°F



13" Circular Kit • Selectable Output Power • Selectable Color Temperature

Catalog Number	Input Voltage	Dimming Type	Selectable Wattage	Selectable Color Temp.	CRI	Total Lumens	System Efficacy
KT-RKIT28PS-13CP-8CSC-VDIM	120-277V	0-10V	21W	3000K	>80	3,100	148 lm/W
				3500K	>80	3,125	149 lm/W
				4000K	>80	3,150	150 lm/W
				5000K	>80	3,200	152 lm/W
			28.5W	3000K	>80	4,100	144 lm/W
				3500K	>80	4,125	145 lm/W
				4000K	>80	4,150	146 lm/W
				5000K	>80	4,200	147 lm/W





NEW! 6" POWER AND COLOR SELECT RECTANGULAR LED KITS

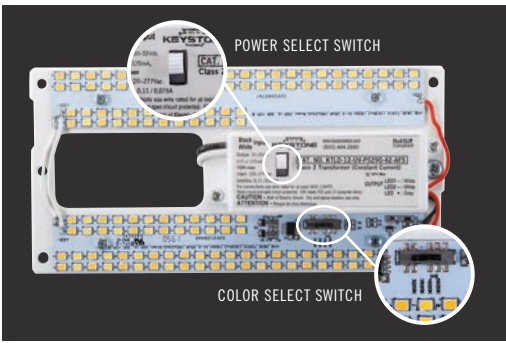

Each pre-assembled UL Classified 1598C kit includes (1) LED driver, (2) LED modules, (1) metal pan, mounting hardware, and accessories

SYSTEM FEATURES

- Power level and color temperature are selectable via slide switches
- UL Classified; meets FCC Part 15, Class B (Consumer) limit
- Pre-assembled; mounting accessories included
- Operating temperature: -20°C/-4°F to 45°C/113°F



6" Rectangular Kit • Selectable Output Power • Selectable Color Temperature

Catalog Number	Input Voltage	Selectable Wattage	Selectable Color Temp.	CRI	Total Lumens	System Efficacy
KT-RKIT12PS-6RP-8CSC	120-277V	8W	3000K	> 80	1,050	131 lm/W
			3500K	> 80	1,075	134 lm/W
			4000K	> 80	1,110	139 lm/W
			5000K	> 80	1,150	144 lm/W
		12W	3000K	> 80	1,550	129 lm/W
			3500K	> 80	1,575	131 lm/W
			4000K	> 80	1,600	133 lm/W
			5000K	> 80	1,650	138 lm/W

TYPICAL INSTALLATION APPLICATION

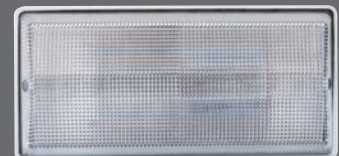

NEW! 11" POWER AND COLOR SELECT RECTANGULAR LED KITS

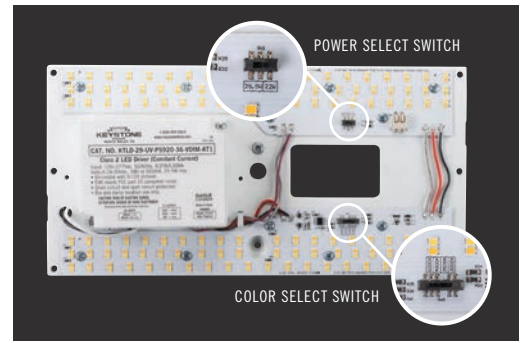

Each pre-assembled UL Classified 1598C kit includes (1) LED driver, (2) LED modules, (1) metal pan, mounting hardware, and accessories

SYSTEM FEATURES

- Power level and color temperature are selectable via slide switches
- UL Classified; meets FCC Part 15, Class B (Consumer) limit
- Pre-assembled; mounting accessories included
- Operating temperature: -20°C/-4°F to 45°C/113°F



11" Rectangular Kit • Selectable Output Power • Selectable Color Temperature

Catalog Number	Input Voltage	Dimming Type	Selectable Wattage	Selectable Color Temp.	CRI	Total Lumens	System Efficacy
KT-RKIT30PS-11RP-8CSC-VDIM	120-277V	0-10V	22W	3000K	> 80	3,100	141 lm/W
				3500K	> 80	3,125	142 lm/W
				4000K	> 80	3,150	143 lm/W
				5000K	> 80	3,200	145 lm/W
			29.5W	3000K	> 80	4,100	139 lm/W
				3500K	> 80	4,125	140 lm/W
				4000K	> 80	4,150	141 lm/W
				5000K	> 80	4,200	142 lm/W

TYPICAL INSTALLATION APPLICATION

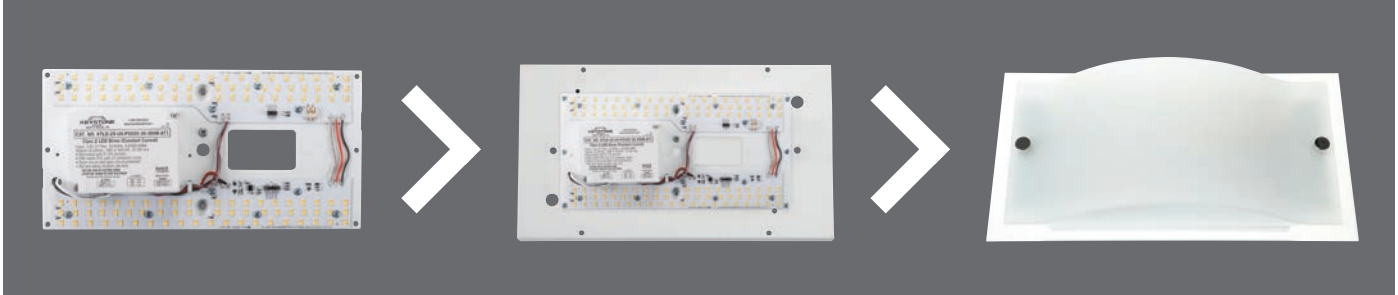



PRODUCT FEATURES

- L70 > 50,000 hours
- Operating temperature: 0°F-104°F, -18°C-40°C
- High power factor >0.90; THD <20%
- T24 JA8 Compliant (90CRI 2700K and 3000K only)
- Suitable for fully enclosed fixtures
- 5% minimum dimming, low flicker
- Pre-assembled with metal heatsink 5VA cover; comes with mounting accessories



COMPATIBLE DIMMERS*

Manufacturer	Model Number	Manufacturer	Model Number
Lutron	S-600PR-WH	Lutron	MACL-153MH-LA
Lutron	TGCL-153PH-WH	Leviton	WA-RXX-06674-12A

*For compatibility with other dimmers, contact Keystone

90 CRI AC LED Light Engines

3" ROUND

Catalog Number	Color Temp	CRI	Wattage	Lumens	Efficacy	Input Voltage	Dimming Method
10W							
KT-RKIT10AC-3C-927-FDIM	2700K	>90	10W	700	70 lm/W	120V	Phase Control
KT-RKIT10AC-3C-930-FDIM	3000K	>90	10W	750	75 lm/W	120V	Phase Control
KT-RKIT10AC-3C-940-FDIM	4000K	>90	10W	800	80 lm/W	120V	Phase Control
KT-RKIT10AC-3C-950-FDIM	5000K	>90	10W	820	82 lm/W	120V	Phase Control

EQUIVALENTS

- 1 x 60W Incandescent
- 1 x 18W CFL

4" ROUND

Catalog Number	Color Temp	CRI	Wattage	Lumens	Efficacy	Input Voltage	Dimming Method
17W							
KT-RKIT17AC-4C-927-FDIM	2700K	>90	17W	1,100	65 lm/W	120V	Phase Control
KT-RKIT17AC-4C-930-FDIM	3000K	>90	17W	1,200	71 lm/W	120V	Phase Control
KT-RKIT17AC-4C-940-FDIM	4000K	>90	17W	1,300	72 lm/W	120V	Phase Control
KT-RKIT17AC-4C-950-FDIM	5000K	>90	17W	1,340	74 lm/W	120V	Phase Control

EQUIVALENTS

- 2 x 40W Incandescent
- 2 x 11W CFL
- 20W T9 Circline

7" ROUND

Catalog Number	Color Temp	CRI	Wattage	Lumens	Efficacy	Input Voltage	Dimming Method
28W							
KT-RKIT28AC-7C-927-FDIM	2700K	>90	28W	2,046	74 lm/W	120V	Phase Control
KT-RKIT28AC-7C-930-FDIM	3000K	>90	28W	2,160	80 lm/W	120V	Phase Control
KT-RKIT28AC-7C-940-FDIM	4000K	>90	28W	2,220	82 lm/W	120V	Phase Control
KT-RKIT28AC-7C-950-FDIM	5000K	>90	28W	2,280	83 lm/W	120V	Phase Control

EQUIVALENTS

- 2 x 75W Incandescent
- 2 x 18W CFL
- 32W T9 Circline

80 CRI AC LED Light Engines

3" ROUND

Catalog Number	Color Temp	CRI	Wattage	Lumens	Efficacy	Input Voltage	Dimming Method
8W							
KT-RKIT8AC-3C-830-FDIM	3000K	>80	8W	750	93 lm/W	120V	Phase Control
KT-RKIT8AC-3C-840-FDIM	4000K	>80	8W	770	96 lm/W	120V	Phase Control
KT-RKIT8AC-3C-850-FDIM	5000K	>80	8W	790	98 lm/W	120V	Phase Control

EQUIVALENTS

- 1 x 60W Incandescent
- 1 x 18W CFL

4" ROUND

Catalog Number	Color Temp	CRI	Wattage	Lumens	Efficacy	Input Voltage	Dimming Method
12W							
KT-RKIT12AC-4C-830-FDIM	3000K	>80	12W	1,100	92 lm/W	120V	Phase Control
KT-RKIT12AC-4C-840-FDIM	4000K	>80	12W	1,120	93 lm/W	120V	Phase Control
KT-RKIT12AC-4C-850-FDIM	5000K	>80	12W	1,150	96 lm/W	120V	Phase Control

EQUIVALENTS

- 2 x 40W Incandescent
- 2 x 11W CFL
- 20W T9 Circline

5.5" ROUND

Catalog Number	Color Temp	CRI	Wattage	Lumens	Efficacy	Input Voltage	Dimming Method
16W							
KT-RKIT16AC-5C-830-FDIM	3000K	>80	16W	1,650	103 lm/W	120V	Phase Control
KT-RKIT16AC-5C-840-FDIM	4000K	>80	16W	1,670	104 lm/W	120V	Phase Control
KT-RKIT16AC-5C-850-FDIM	5000K	>80	16W	1,700	106 lm/W	120V	Phase Control

EQUIVALENTS

- 2 x 60W Incandescent
- 2 x 13W CFL
- 20W T9 Circline

7" ROUND

Catalog Number	Color Temp	CRI	Wattage	Lumens	Efficacy	Input Voltage	Dimming Method
19W							
KT-RKIT19AC-7C-830-FDIM	3000K	>80	19W	1,970	103 lm/W	120V	Phase Control
KT-RKIT19AC-7C-840-FDIM	4000K	>80	19W	2,050	108 lm/W	120V	Phase Control
KT-RKIT19AC-7C-850-FDIM	5000K	>80	19W	2,100	110 lm/W	120V	Phase Control
25W							
KT-RKIT25AC-7C-830-FDIM	3000K	>80	25W	2,450	98 lm/W	120V	Phase Control
KT-RKIT25AC-7C-840-FDIM	4000K	>80	25W	2,500	100 lm/W	120V	Phase Control
KT-RKIT25AC-7C-850-FDIM	5000K	>80	25W	2,520	101 lm/W	120V	Phase Control

EQUIVALENTS

- 2 x 75W Incandescent
- 2 x 18W CFL
- 32W T9 Circline



SINCE 1945
KEYSTONE
LIGHT MADE EASY®