

# LED Uplight Parking Garage Canopy Series

Wattages: 28W, 42W, 56W, 70W



LBS Lighting's LED Uplight Parking Garage Canopy Lighting series can be widely used in indoor or outdoor lighting (wet location), like parking garages, mechanical or electronic processing workshops, storage warehouses, steel mills, gas stations, toll booth, waiting rooms, the platforms of railway station, indoor stadiums and lower cultivating tents etc.

Lighting controls meet design lights consortium (DLC) networked lighting control system technical requirements, LLLC, Energy Monitoring and High End Trim function.



## FEATURES

- LED high luminous efficiency and long working life.
- High efficiency LED Driver, the wide range input voltage AC120-277V.
- Die-cast aluminum cooling design, high quality and better cooling for LED  $T_j < 85^{\circ}\text{C}$ .
- Excellent optics design, greatly improve the light utilization and evenness.
- Photocell, motion sensor control available (Optional)
- The 1-10V Dimming type is continuous

## DIMENSION

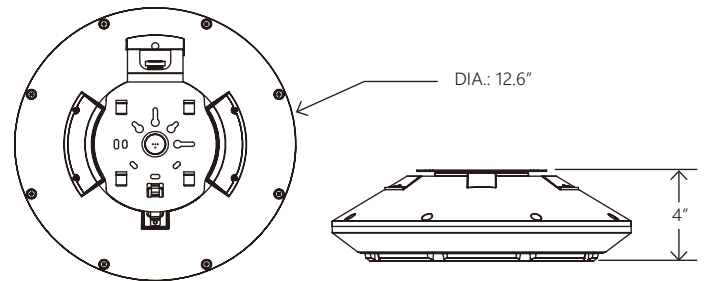

## SPECIFICATION

TYPE								
WATTAGE	28W		42W		56W		70W	
CCT	4000K	5000K	4000K	5000K	4000K	5000K	4000K	5000K
LUMEN	4326 lm	4246 lm	5818 lm	5713 lm	7321 lm	7137 lm	9080 lm	8790 lm
EFFICACY	>140 lm/W							
UPLIGHT (%)	11.4%							
CRI	70							
INPUT VOLTAGE	AC120-277V							
BEAM ANGLE	156°							
POWER FACTOR	0.90							
DRIVER EFFICACY	90%							
FACTORY SETTINGS	70W & 4000K							
LIFE SPAN	over 50,000 hrs							
WORKING TEMPERATURE	-22°F ~ 113°F							
STORAGE TEMPERATURE	-40°F ~ 176°F							
OUTDOOR RATING	Wet location							
CABLE	3 core, 18AWG (0.3m)							
WARRANTY	5 year limited							

# LED Uplight Parking Garage Canopy Series

Wattages: 28W, 42W, 56W, 70W

Motion sensor ready

Optical lens is made of high quality PC material to make the light even and soft.



Top tier LEDs are driven well below recommended safety limits, on both drive current and junction temperature, to keep components cool – maintaining the life of the LED, allowing for a compact and efficient heat sink design.



The uplight contains a certain proportion of upward light to satisfy the visual effect.

High performance, die cast heat sink transfers heat from the light engine to the environment, via large cooling fins, drawing heat away from the fixture, and extending the lifespan of the LEDs.



**WATT/CCT**  
**SELECTABLE**

POWER:28W/42W/56W/70W  
CCT:4000K/5000K

## EMERGENCY BACK-UP (SOLD SEPARATELY)



**EMS8W27-XX** 8W  
Emergency Backup  
Battery LED Driver



**EMS15W27-XX** 15W  
Emergency Backup  
Battery LED Driver



**EMS20W27-XX** 20W  
Emergency Backup  
Battery LED Driver

## CONTROL (SOLD SEPARATELY)



**Bluetooth**

**BRI823-B-D-BLE-SR**  
Bluetooth Microwave  
Motion Sensor



**BRI823-B-D**  
Microwave Motion Sensor



**RC100**  
Remote Controller

## ACCESSORIES (SOLD SEPARATELY)



**WSD-LS-UPGC**  
Lens Shade

## ORDERING INFORMATION

EXAMPLE:

**WSD-UPGC2842567W27-45K-Z[D, W, B, S]-Y[BLANK, P]-E[BLANK, M]**

LBS	UPGC	2842567W	27	45K	Z	Y	E
COMPANY	PRODUCT	WATTAGE	VOLTAGE	CCT	FINISH	CONTROL 1	CONTROL 2
LBS	UPGC (Up Light Garage Canopy)	28W - (28W) 42W - (42W) 56W - (56W) 7W - (70W)	27 (AC120-277V)	4K - (4000K) 5K - (5000K)	D - (Darkr Bronze) W - (White) B - (Black) S - (Silver)	P - (Photocell)	M - (Motion Sensor)

# LED Uplight Parking Garage Canopy Series

Wattages: 28W, 42W, 56W, 70W



## BRI823-B-D-BLE-SR

The BRI823-B-D-BLE-SR uses PIR motion detector architecture and passive infrared (PIR) technology for improved detection coverage for high bay applications.

### FEATURES

- Bluetooth to 0-10V signal converter, Bluetooth mesh network.
- Built-in 20mA 0-10V signal output.
- Easy commissioning with Mobile App (Available in IOS).
- Mesh network, which has a much longer control distance, transmits received signals to neighboring devices.
- All devices on 0-10V line are broadcast controlled by mobile application.
- In typical outdoor environment, the typical range for wireless communication is 200ft(60m).
- Actual range is dependent on field installation.
- Available with Magnetic reset (Touch the top part of sensor for 5 seconds).
- On-board antenna.

### DIMENSION

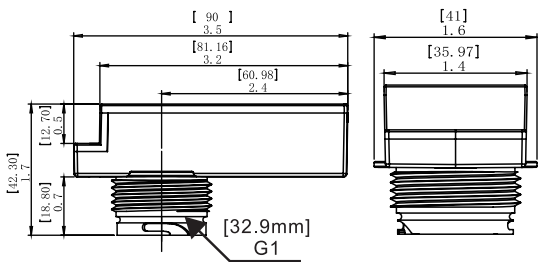

### COVERAGE

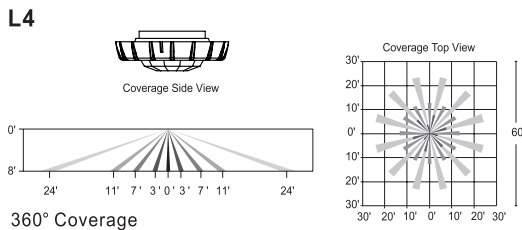
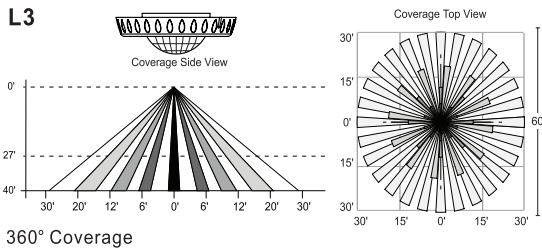

### COMMISSIONING

Silvair iOS App makes it easy to pair devices, create groups, set scenes/schedules, customize dimming levels, and adjust high trim based on application needs.

### SPECIFICATION

NETWORK BLE MESH	Yes
DAYLIGHT HARVESTING	Yes
MICROWAVE MOTION SENSOR	Yes
DETECTION	360°
OPERATING VOLTAGE	120/277 Vav
OPERATING CURRENT	5A
SINKING CURRENT	max. 25mA
CONTROL OUTPUT	0-10V
MOTION SENSING	Passive IR
WIRELESS STANDARD	BLE 5.0 MESH
PROGRAMMING	Silvair iOS App ( IOS )
CYBERSECURITY	UL
LEN L3 (HIGH BAY)	Max.detection radius 30ft;Max.mounting height 40ft
LEN L4 (LOW BAY)	Max.detection radius 30ft;Max.mounting height 25ft
MAX BLUETOOTH RANGE	200ft (60m)
FCC	FCC
OPERATING TEMP.	-40°C - +70°C
IP RATING	IP65
WARRANTY	5 year limited

Please scan and download the app.



iOS

Operation Instruction:  
[https://youtu.be/8KWPK7z\\_Tng](https://youtu.be/8KWPK7z_Tng)



# LED Uplight Parking Garage Canopy Series

Wattages: 28W, 42W, 56W, 70W

## GateWay Remote Control

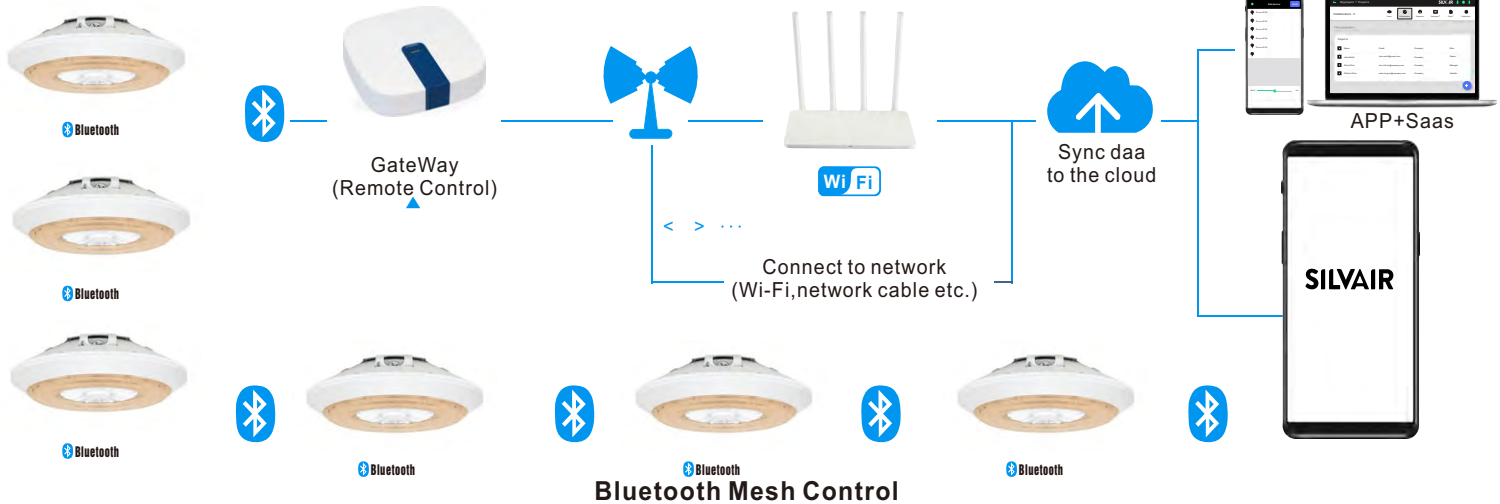

### Functions:

The Silvair Gateway enables the following functions in the Silvair web app: •

- Scheduling (available by default)
  - Scheduling changes in scenes and lighting control scenarios (for example occupancy sensing, daylight harvesting) for specific times or days.
- Energy and occupancy monitoring (additional paid service)
  - Visualizing energy use and occupancy via the Silvair web app.
  - Downloading energy and occupancy via the Silvair web app and cloud-based API.
- Remote monitoring and control (additional paid service)
  - Low-latency monitoring of the status of devices in the network via API.
  - Low-latency control of devices in the network via API. • System diagnostics
    - Monitoring of the status of Bluetooth mesh networks.
    - Remote troubleshooting of networking issues.

### Features:

- Future-proof Linux operating system.
- Simple commissioning using the Silvair Commissioning tools.
- Automatic connection to the Silvair cloud.
- Secure provisioning with secure IDs and encrypted keys.
- High level of hardware and software security (secure boot and encrypted file system can only be accessed with the management platform).
- Automatic security updates.
- Prompt releases of OS updates and fixes to vulnerabilities.
- Low-latency transfer of network, luminaire, and sensor status data to the Silvair cloud.
- Schedule caching.
- Automatic remote firmware updates.
- Display of gateway and network performance metrics (requires the Silvair web app).

## INDUSTRIAL GATEWAY

### SGW-101

Smart Engineering Gateway

The Silvair Gateway connects Bluetooth mesh networks that have been commissioned using the Silvair Commissioning tools to the Silvair cloud. This allows the scheduling of events and delivery of services based on the data generated by these networks.

### SPECIFICATION

<b>POWER SUPPLY</b>	4.5–5.5 V DC, 2 A Power over Ethernet 36–57 V DC (IEEE 802.3af)
<b>OPERATING SYSTEM</b>	Ubuntu Core
<b>PROCESSOR</b>	i.MX6ULL (Y2), 32-bit ARM 800 MHz
<b>MEMORY</b>	512 MB DDR3L SDRAM 8GB eMMC
<b>COMMUNICATION PROTOCOLS</b>	Bluetooth mesh (2.4 GHz Bluetooth Low Energy) Wi-Fi 802.11a/b/g/n/ac (2.4/5 GHz) 4G LTE Cat 1 with 2G/3G (only for Cascade-500-W and Cascade-500-X gateways)
<b>PORTS</b>	1 x RJ45 10/100 Ethernet 1 x USB 2.0 Type-A 2 x external dipole antenna, 5 dBi (only for Cascade-500-W and Cascade-500-X gateways)
<b>REQUIRED AMBIENT TEMPERATURE</b>	0°C to 60°C 32°F to 140°F
<b>ENCLOSURE DIMENSIONS</b>	127 mm x 127 mm x 30 mm (5 inch x 5 inch x 1.2 inch)
<b>MOUNTING POSITION</b>	Wall or surface mounted. As close to the geometrical center of the lighting network as possible, but as far as possible from potential sources of interference.
<b>SECURITY</b>	Secure boot with encrypted operating system Secure communication with the Silvair Cloud over Internet (TLS) Secure communication with devices over qualified Bluetooth mesh

# LED Uplight Parking Garage Canopy Series

Wattages: 28W, 42W, 56W, 70W

## PHOTOMETRICS

For complete IES files, please visit our website.

### WSD-UPGC2842567W27-45K (70W&4000K)

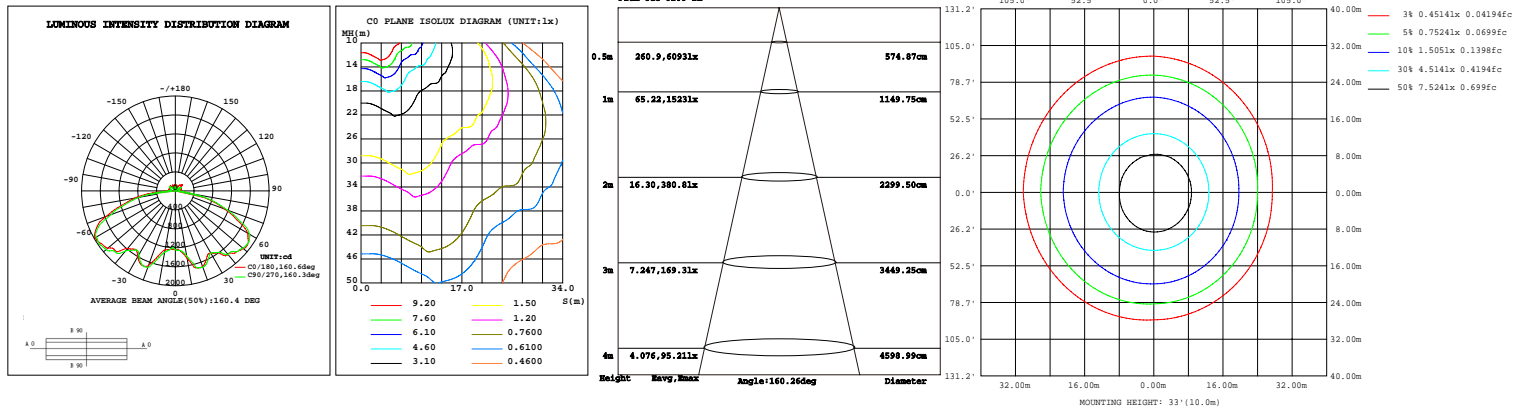

### WSD-UPGC2842567W27-45K (70W&5000K)

