



TPG7 | Acorn Post Top Light



Specifications

Model	YR-PPG060-115 (60W) / YR-PPG100-023 (100W)
LED Chip	SMD 3030, Lumileds or Other LED Chips
Wattage	30W- 50W- 60W / 60W- 80W- 100W Power Selectable
CCT	3000K / 4000K / 5000K 3CCT Selectable
Light Output	Max 6600lm / Max 11000lm
Efficacy	110LM/W (Can customize higher LM/W if needed)
AC Input Voltage	120~277V / 277-480V
Light Distribution	Type V
Exclusive Feature(1)	Button Photocell Sensor Available
Exclusive Feature(2)	Acrylic Diffuser / PC Diffuser Optional
Exclusive Feature(3)	3CCT / Power Tunable (3000K/4000K/5000K)
Ambient Temperature	-40°C to +45°C(-40°F to +113°F)
Total Harmonic Distortion (THD)	< 20%
Lifetime	50,000H
IP Rating	IP65
Warranty	5 years



CCT Select



Power Select



Photocell sensor



ADC12 Die casting

Button Photocell Sensor (Optional)



CCT Select & Power Select



Dimension

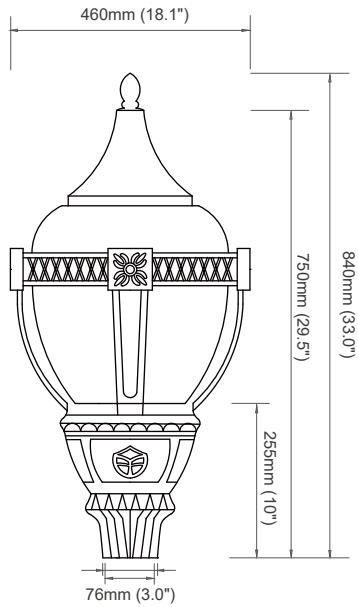

YR-PPG060-115

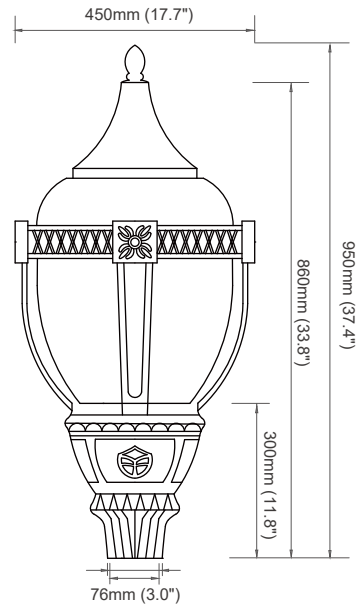

YR-PPG100-023

Applications



Street / Walkway



Community

Light Distribution

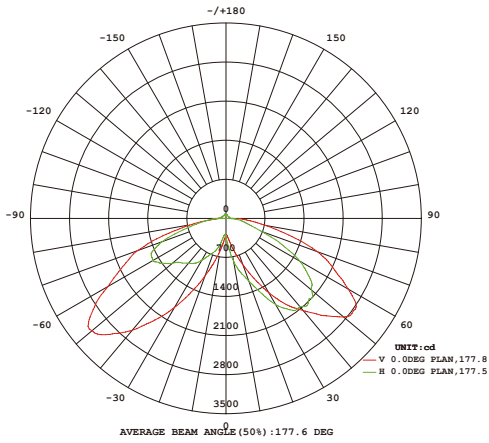

Installation

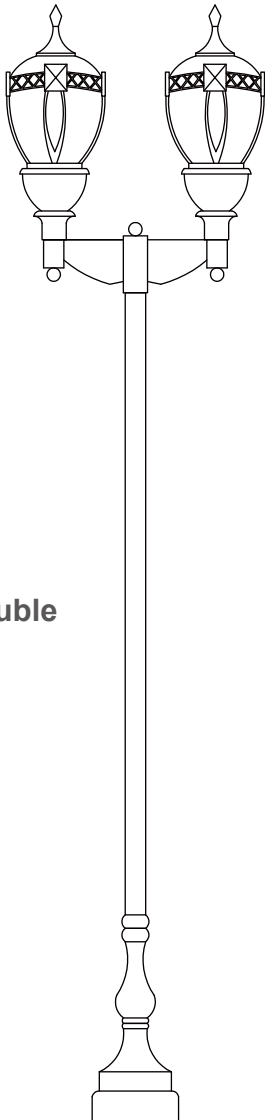

Double



Single

Packaging information

Wattage	Product Dimension (mm/in)	Carton Box Dimension (mm/in)	N.W (Kg/lb) (1pc)	G.W (Kg/lb) (1ctn)	qty/ctn
60 Watt YR-PPG060-115	460 x 460 x 840 mm 18.10 x 18.10 x 33.00 in	540 x 540 x 895 mm 21.26 x 21.26 x 35.24 in	6.2Kg(13.67lbs)	9.0Kg(19.80lbs)	1 PCS
100 Watt YR-PPG100-023	450 x 450 x 950 mm 17.70 x 17.70 x 37.40 in	540 x 540 x 980 mm 21.26 x 21.26 x 38.58 in	8.5Kg(18.74lbs)	11.8Kg(26.00lbs)	1 PCS

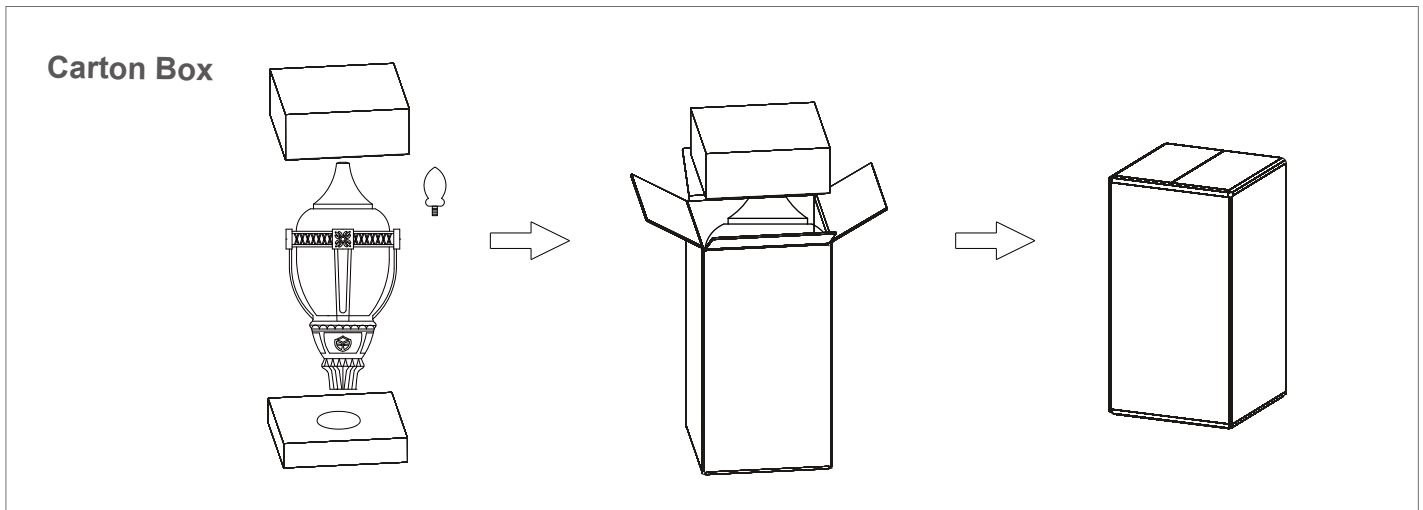

Contractor Essentials by Light Bulb Surplus

5481 Bryant Ave South, Sanford FL 32772
 Phone: 888-553-5655
 Web: www.LightBulbSurplus.com